



Form 180 Blue

Taylor-English

Coal Co., #1

mine index: 3881

County No. = 284

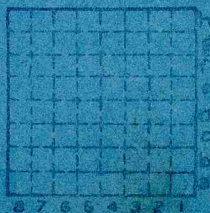

Sec. 35 F8

T. 19 N S.

R. 12 W

Index No.

Location and Elevation Data

Location: Exact Approximate
 (Approximate only if no trace of record of original exists)
 Location by G.M. Wilson
 Date 1945 Notebook No. 667 Page 67-2671
 Looseleaf ref. no microfilm map
 Map files No. 14-92-42C

Description of Location

Position in sec., 1/4 sec., 40 acres

..... feet from North line
4980 feet from East line
~~210~~ 3610
~~4980~~ feet from South line
270 feet from West line

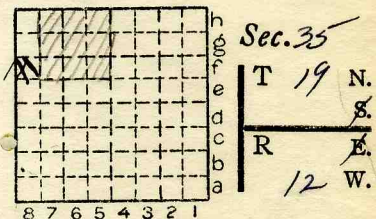

Other description:

ABD 1925 1920
Co-op Min. Bolk. #14
Depth
153' to 6'0" of #9 coal
at main shaft

Farm.....
 No.....
 Company (DANVILLE
COLLIERIES)
TAYLOR-ENGLISH
 No. 1
 County No. ~~1000~~

Elevation 660.1 ft.
 By G.M.W.

Method: Level, transit, alidade, hand level

Elevation of GROUND
 Height of point above ground.....
 Date..... Notebook..... P.....
 Looseleaf ref.....

Map files No.....
 Description of item: (drill hole, mine, etc.) AIR SHAFT, ABD MINE

County VERMILION Quadrangle DANVILLE Index No. 1835 ~~BB~~



Location and Elevation Data

Location: Exact Approximate
 (Approximate only if no trace of record of original exists)
 Location by G.M.W. 1200
 Date 1945 Notebook No. 667 Page 67-2640
 Looseleaf ref. 7
 Map files No. 14-92-42-C

Description of Location

Position in sec., 1/4 sec., 40 acres

..... feet from North line
5175 feet from East line
3480 feet from South line
75 feet from West line
 # 7 148 - 56" (514)
 # 6 181 - 56" (481)

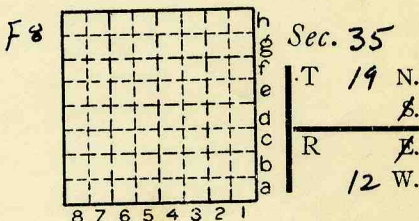

Other description: operating 1900
1900 Coffin Co.
1903 Jones & Adams C.C. #2
1905 Chicago Collieries #10
1908 Danville Collieries
1918 Taylor English Coal Co. #1

Farm.....
 No.....
 Company Taylor English Coal Co.
 No. 1
 County No. 284

Elevation 662.0 ft.
 By G.M.W.

Method: Level, transit, alidage, hand level

Elevation of Ground at shaft
 Height of point above ground.....
 Date..... Notebook..... P.....
 Looseleaf ref.....

Map files No.....
 Description of item: (drill hole, mine, etc.) Mine shaft Abandoned

County Vermilion Quadrangle Danville Index No. 1835 F8

Company Catlin C.C. - Taylor English No. 1 Drill Hole No. _____

Mine or Prospect Shaft Mine Farm _____

Date Drilled _____ Drilled by _____ Driller _____

Elevation 660 ETM by _____ Method _____

Location: County Vermilion County Number _____

Main shaft: 106' WL sec. 35
1795' NL

Airshaft: 264' WL sec. 35
1637' NL

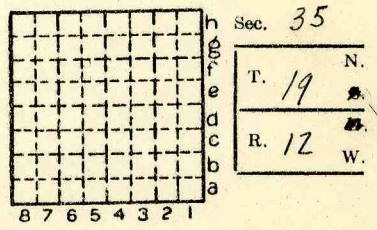

Quadrangle Danville SW

Core Description

Collected _____
or
Logged by: _____ Recorded by _____

Date _____ Total Depth _____

Core logged from _____ to _____

Samples taken: _____

General Remarks: _____



FORM 180 W

Production For: Catlin C.C. - Taylor

Year	Production	Year	Production
1896	Catlin C.C. 26,560		
1897	Catlin C.C. 81,016		
1898	86,157		
1899	157,760		
1900	175,000		
1901	179,829		
1902	145,011		
1903	156,368		
1904	135,671		
1905	Chicago Collieries Co. No. 10 74,162		
1906	53,637		
1907	7,100		
1908	Danville Collieries 15,000		
1909	40,684		
1910	44,465		
1911	104,324		
1912	115,176		
1913	112,738		
1914	88,161		
1915	80,965		
1916	86,000		
1917	51,988		
1918	Taylor-English C.C. No. 1 47,211		
1919	25,777		
	<u>2,090,760</u>		



Mine originally operated by: (1)

Date

CATLIN COAL CO.

ANTE 1900

Original name or number: No. 1.
 Illinois Coal Report p.

LATER OPERATORS

Date	Operator	Name or No.
2 1903.	JONES & ADAMS COAL CO.	No. 2.
3 1905	CHICAGO COLLIERIES	No. 10.
4 1908	DANVILLE COLLIERIES	No. 1.
5 1918	TAYLOR ENGLISH COAL CO.	No. 1.
6		
7		
8		
9		
10		
11		
12		
13		
14		

Idle - 1920 - 1923. Reopened 1924

*Also owners

#See ownership sheet

Railroad, Wagon, Strip, Idle, Abandoned **SHAFTMINE**

SHIPPING MINE

IDENTIFICATION

County No. 284

Coal No. 1925

Coal Report No. _____

Quad. DANVILLE

County VERMILION

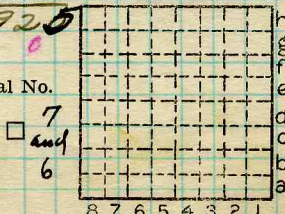

Sec. 35

T. 19 N. S.

R. 12 E. W.

Index No.

1835 F8

COAL MINE OPERATOR

Co. No. _____ County _____ Sec. _____ T. _____ R. _____ T.&R. _____

Company Taylor-English C.C. No. 2 Farm Fred White No. _____

Elev. _____ of _____ by _____ Total depth _____ Year drld. 1918

For M Method S Result A Type log _____ Core desc. _____

Stripped _____ Analysis _____ Confd. _____ Publ. _____

Location on West side of Collins on C + E I R.R.

Core logged _____ by _____

Remarks: _____

KEY BEDS

Code	Name	Depth	Thk.	Elev.

This mine is sec 3 T 18 N R 12 W

Correlations by _____ basis _____

Date _____ Quad. _____

County Vermilion Co. No. _____

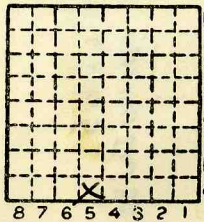

Sec. 35

T. 19 N. 1

R. 12 W. 1

(41388-271-2-28)



Com. No.

Com. No.

Date

Group

pa

pages

Conclusions

Faint handwritten notes, possibly "The map of Bunsen cc Kelta No 5"

This a map of Bunsen cc Kelta No 5
Index 3740. Closed 1912 - 19N 11W Sec 32

4103 .V4 15.1-98



Geo. H. S.

Tract 1

SW $\frac{1}{4}$ Sec 34 lying S of Wabash RR in
T19N R12W,

E $\frac{1}{4}$; SW $\frac{1}{4}$; NE $\frac{1}{4}$; and E $\frac{1}{2}$, E $\frac{1}{2}$ Sec 4
all of Sec 3, T18N, R12W, containing 56 acres
more or less of No 6

Tract 2

NW $\frac{1}{4}$ NE $\frac{1}{4}$ Sec 35 T19N R12W
containing 40 acres of No 6 coal.