



Location and Elevation Data

Location: Exact Approximate
 (Approximate only if no trace of record of original exists)

Location by.....
 Date..... Notebook No..... Page.....
 Looseleaf ref.....
 Map files No. 14-92-43

Description of Location

Position in sec., 1/4 sec., 40 acres

..... feet from North line
1150 feet from East line
1525 feet from South line
 feet from West line

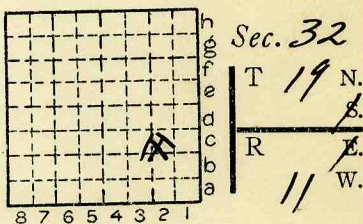

Other description: Opening 1900
ABO 1908
40' to 6'6" #6 (Coal rept. data)
44 Acres S. of opening ±
30 Acres N. of opening ±

Farm.....
 No.....
 Company BLUE BIRD
COAL Co.
(John O'Connell)
 No.....
 County No. ~~1732~~

Elevation..... ft.
 By.....

Method: Level, transit, alidade, hand level

Elevation of.....
 Height of point above ground.....
 Date..... Notebook..... P.....
 Looseleaf ref.....

Map files No.....
 Description of item: (drill hole, mine, etc.) SHAFT MINE ABO

County Vermilion Quadrangle 149 Index No. 173202
 (50167-5M-2-38) 2



Mine originally operated by: (1)

Date

~~ANTE 1900~~ ~~BLUE BIRD COAL CO.~~

Original name or number: ~~JOHN O'CONNELL~~
 Illinois Coal Report _____ p. _____

LATER OPERATORS

Date	Operator	Name or No.
2 1896	O'Connell & Hume	
3 1897	Jno. O'Connell	
1898	idle	
4 1900	Jno. O'Connell,	Blue Bird
5 1901	J. O'Connell CC.	
6 1904	J. O'Connell C.C.,	Bluebird.
7 1905	Jno. O'Connell CC.,	Bluebird
8		
9		
10		
11		
12		
13		
14		

*Also owners

#See ownership sheet

Railroad, Wagon, Strip, Idle, Abandoned

SHAFTMINE

IDENTIFICATION

County No. _____

Coal No. _____

Coal Report No. _____

6

Quad. DANVILLE
 County VERMILION

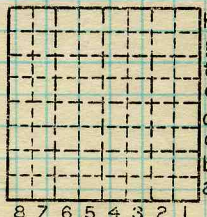

Sec. 32

T. 19 N. 8.

R. 11 W. 8.

Index No.

COAL MINE OPERATOR

173202

