

2009



Form 180

Co No. ~~18~~ 9

Mng. Assn.  
Mt. Pulaski (Colliery Co.)  
M. I 578

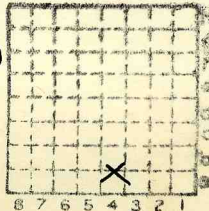

Sec	14
Tl	18
R.	2
Index No.	

✓

Mine Index: 278                      Mt. Pulaski

Type: Underground                      Total Mined-out Acreage Shown:

**SHAFT, SLOPE, DRIFT or TIPPLE LOCATIONS**

Type	County	Twp	Section	Quarters-Footage
Shaft	Logan	18N 2W	14	SW SE

**GEOLOGY**

Seam(s) Mined	Depth (ft)	Thickness (ft)			Mining Method
		Min	Max	Ave	
Springfield	365	3.5	4.3	4.0	LW

Geologic Problems Reported:

**PRODUCTION HISTORY**

Company	Mine Name	Years	Production (tons)
Fox, BF	Fox	1883	NA*
Mt. Pulaski C. C.	Mt. Pulaski	1884-1887	100,800
Union C. C.	Union	1888-1899	181,282
Mt. Pulaski C. C.	Mt. Pulaski	1900-1902	24,439
Home C. C.	Home	1903-1906	47,664
Mutual C. C.	Mutual	1907-1909	41,130
Mt. Pulaski C. C.	Mt. Pulaski	1910-1915	61,976

Last reported production: 1915

457,291

\*Coal production not available

**SOURCES OF DATA**

Source Map	Date	Original Scale	Digitized Scale	Map Type
Logan Co. Quade rept.	11-1934	1:126720	1:6250	Secondary Source map. Date of mine outline unknown.

Annotated Bibliography (data source, brief description of information)

Annual reports of the Il. Dept of Mines and Minerals - Production, ownership, years of operation.

Directory of Il. Coal Mines (Menard Co.) - Mine names, mine index, ownership, years of operation.

ENR Document 85/01 - Mining method.

Mine Notes (Menard Co.) - Thickness, depth, seam, mine type.

Logan Co. Quade Report - Mine outline, shaft location.



Town, **Mt. Pulaski**  
 Local Authority,

Surface alt., **635** ft.  
 Depth to coal, **365?** ft.  
 Alt. top coal, **270** ft.  
 Thickness: Av. in.  
 Max. in., Min. in.

Level: Auth., **Mine notes**

Method,

R. R., **I.C.**

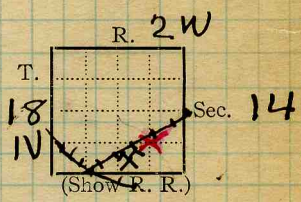

Location: authority, **Lincoln Quad.**  
**abd.**

**After 1883-1912** Operator **Mt. Pulaski Colliery Co.** Mine Name or No. **Home**

19 **Mt. Pulaski Colliery Co.** **Home**

Successor to **Mutual Coal Co. (Home Co.) ?**

Date  
 Succeeded by **1883 +**  
 Date  
 Succeeded by  
 Date

**PRODUCTION.**

										U. S. No.	
19											

Returned unclaimed  
126

Geol. Notes? **Yes** Coop. No. **No.** Coal secs? **No.**  
 Analyses No. **1889**

Examined by \_\_\_\_\_ Ref. \_\_\_\_\_  
 Coal bed name: Local **SHIPPING MINE** Survey No. \_\_\_\_\_  
 County **Logan** Index No. **151472**  
**K.—ACTIVE SHIPPING OR LOCAL COAL MINE.**



Location and Elevation Data

Location: Exact Approximate

(Approximate only if no trace or record of original exists)

Location by W. B. Roe

Date 5-1-31 Notebook No. 602 Page 33-306

Looseleaf ref.

Map files No. 8-54-2c

Description of location

Position in sec., 1/4 sec., 40 acres

feet from North line

feet from East line

feet from South line

feet from West line

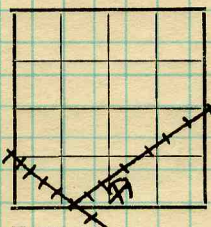

Sec. 14

T. 18 N.

R. 2 W.

Farm

Other description:

No.

Company

Mutual Coal Co

No.

County No. # 9

Elevation 638.0 ft.

By W. B. Roe

Method: Level, transit, alidade, hand level

Elevation of

Alidade  
Ground surface  
0

Height of point above ground

Date 5-1-31 Notebook 602 Page 33-306

Looseleaf ref.

Map files No. 8-54-2c

Description of item: (drill hole, mine, etc.) Mine shaft (old)

County Logan  
(45576-1M-10-30)

Quadrangle Lincoln

Index No. 1514

ILLINOIS COAL MINE NOTES

TOWN *Mount Pleasant* N. R. 2 W. S. 14, SE 1/4. *Logan* CO.  
 COAL BED *Nos* DATE *10/23/08* COLLECTOR *Dewolf*  
 OPERATOR *Mutual C. Co.* MINE # *181514*  
 HEAD OFFICE *Here - NW Clear Creek; John Hines Supt.*  
 CAPACITY *700± Ton* MARKETS, FRT. *Clinton, Ill; local chgs 70¢*  
 ENTRANCE *Shaft 365 (top?) three compartment - 7x14 inside*  
 CAGE *Hand dump, made in Altan* ENGINES *J C Lamb 12" x 24"*  
*Second motion* DRUM *wood on steel*  
 SCREENS *Diamond bar 1/4; Revolving wire mesh 1/2" x 1/2" 3 sizes*  
 STORAGE *None*  
 VENTILATION *Homemade wood, reversible - 16" d.*  
 GAS, SOURCE *None.*  
 COAL THICKNESS, AV *4'* MAX *4 1/2"* MIN *3 1/2"* ELE. *Shift @ RR level;* FT.

SECTION LOCATED *R9 off back east of Main South; 2000' SE from shaft*

No.		In.	ft.	In.
1	<i>C</i>	<i>33</i>	<i>7</i>	
2	<i>Self lane</i>	<i>1 1/2</i>	<i>8</i>	
3	<i>C</i>	<i>12</i>	<i>9</i>	
4			<i>10</i>	
5			<i>11</i>	
6				<i>46 1/2</i>

NOT SHIPPED *2* NOT INCLUDED *2* CAN *5* SAMPLE *3484*  
*Somewhat moist.*

PHYSICAL PROPERTIES BY NOS. *all fairly hd but blk. Blocky.*  
*not req but common; another locally 6" higher*  
*0 - 1 1/2"*

ROOF *Repts slate 0 to 4', or 2', above it "ls" 6" - repts rd in shaft? Above grs sh*  
 FLOOR *7c repts 10'+; same heav.*

DIP *Rolly, nearly level* CLEAT *NG 60° E - moderate*

FAULTS, ETC. *Traces of faults bad. 2" - 2';*

MACHINES *None - shot off solid*

HAULAGE *Mules - face to shaft. 2' x 4' wood in rooms; talk out*  
*entire narrow cars off track easily*  
 CARS *Wood 1/2 - 20 hundred T*

DRAINAGE *Water box hauled to shaft. Pump 2 hrs.*

WORKING SYSTEM *R & O. Formerly W. 5 yrs ago.* ROOMS *@ 12 wide - then 28' x 150'; 9 in ch*

ENTRIES, MAIN *12'* CROSS *12'; 300' apart* ROOM *12'*

PILLARS, MAIN *46'* CROSS *stubs -* TIMBERS *Entry OK at shaft*  
 DRAWN *no. Formerly yes.* *6 below where scant bit badly needed. Poor management.*  
*Co has 1200 tons; Values here 30.00 dollars per c.*  
 Note also: Variation in coal, impurities, roof, structure.  
 Collect records, analyses, fossils. Note land values, etc. *See John Jph*  
*#1889 for log* *1514*

Mt Pulaski

Loyan Co.

reptd like Riverton log

From Mr. John Zah Jr - 7K, 1514

Soapstone		15±	
l.s. cap rock		1' 4'	
slate			
Coal #5 of Shaft		4'	365
f.c. (cat)		6'	
sl bk.		2 1/2'	410
Coal		26"	
f.c. etc		+	
Coal		17"	470
shale		12'	<del>480</del>
Coal		22"	482
f.c. + & mostly ss + grsh.		45'	
Coal blossom of f.c.		+	533

Drilling from here

sh. 12'± ss 41'± bk sl 2" - nigger head 3/4",  
 then coal 26" - - + f.c. 5"  
 Finished

Reports "horseback" from 410 - 470?

✓ Write Walter Munday - Real Est etc  
 Lincoln for logs of gas wells, Lou  
 Foley place - & 1 other.

\*18\*14  
 1514