





Location and Elevation Data

Location: Exact Approximate  
 (Approximate only if no trace of record of original exists) *Ext.*  
 Location by *W.P.A. Photostat map Mine map in Coal Div files 7-29-29*  
 Date ..... Notebook No. .... Page.....  
 Looseleaf ref. ....  
 Map files No. .... *W.P.A. photostat - Ext. 5-19-37*

Description of Location

Position in sec., 1/4 sec., 40 acres

.....feet from North line  
 .....feet from East line  
 .....feet from South line  
 .....feet from West line

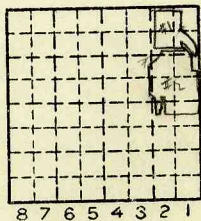

Farm .....  
 No. ....  
 Company *United Electric Coal Co.*  
 No. *←* .....  
 County No. *14 (Slope #18#2)*

Other description: *No. 7 coal*

*#1 Abd.-1929*  
*Loc. Portal #1 ✓* *Loc. Portal #2 ✓*  
*Mouth of slope*  
*625'S } NE cor. 1890's } NW cor*  
*510'W } Sec. 21 35'E } Sec. 22*  
*Air shaft } 90'W, } NE cor*  
*both portals } 1375'S } Sec. 21*

Elevation *Portal No. 1 555'* ft.  
 By *Portal No. 2 550'*

Method: Level, transit, alidade, hand level  
*~ 20'-25' to 5'10" No. 7*

Elevation of .....  
 Height of point above ground.....  
 Date ..... Notebook ..... P.....  
 Looseleaf ref. ....

Map files No. ....  
 Description of item: (drill hole, mine, etc.) *Slope mine Abandoned*  
*Summary Coal Rpt. 1930 5'10" #7 coal*  
 County *Vermont* Quadrangle *Danville* Index No. *1821-H1 (#1)*  
*149* *1822-PB (#2)*



Mine originally owned by: (1) **UNITED ELECTRIC COAL CO.**

Date **1927**

Authority

**No. 14.**

**(Two Slopes)**

**LATER OWNERS**

Date

Owner

2

Authority

3

Authority

4

Authority

5

Authority

6

Authority

7

Authority

8

Authority

9

Authority

Railroad, Wagon, Idle, Abandoned

**SHIPPING MINES 1929(#1), 1932(#2)**

**IDENTIFICATION**

County No.

Coal No.



Part

Quad. **DANVILLE**

County **VERMILION**

**SLOPE MINES**

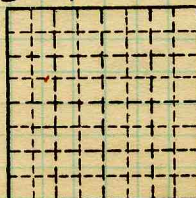

Sec. **21**

T. **19 N.**

R. **8 E.**

R. **12 W.**

Index No.

8 7 6 5 4 3 2 **(#1) 1821 H1**  
**(#2) 1822 F8**

**COAL MINE [REDACTED] OPERATOR**



( Sheets ) COAL PRODUCTION ( Sheet )

Period						Tons	
Mo.	Day	Year	Mo.	Day	Year		
					1927	2	852
					1928	143	849
					1929	172	648
					1930	57	477
					1931	3	459
					1932		

ABD

SUMMARIES

No.	to	No.				
1927		1931			380	285

Railroad, Wagon, Strip, Idle, Abandoned  
 SHIPPING MINES #1 ABD 1929 #2 1932  
 IDENTIFICATION

SLOPE MINES Sec. 21

County No. \_\_\_\_\_

Coal No. \_\_\_\_\_

Coal Report No. \_\_\_\_\_

7

Quad. DANVILLE

County VERMILION

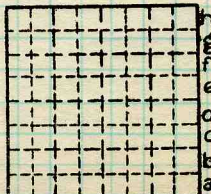

T. 19 N.  
 R. 12 W.  
 Index No.

COAL MINE—PRODUCTION

ILLINOIS GEOLOGICAL SURVEY, URBANA

1821 H1  
 1822 F8





United Electric Coal Co.  
Danville, Ill.

Sec. 21  
T. 19N  
R. 12W

Mine #14 - Oakwood

Location of tipple: S.E.  $\frac{1}{4}$  N.E.  $\frac{1}{4}$  Sec. 21.

New

1930 #10

Q



Town, *Danville*  
Local Authority,

Surface alt., ft.  
Depth to coal, ft.  
Alt. top coal, ft.  
Thickness: Av. in.  
Max. in., Min. in.

Level: Auth.,

Method,

*Sup. Catlin*  
*R. 12W*

R. R. *CCC+StL ; I.T.S.*

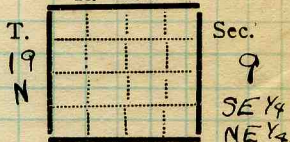

Location: authority, *Co. letter '26*

(Show R. R.)

Operator

Mine Name or No.

*The United Electric Coal Companies*

*# 14*

1926

*Under Construction*  
*226*

Successor to

Date

Succeeded by

Date

Succeeded by

Date

**PRODUCTION.**

							U. S. No.
19							

Geol. Notes?

Coop. No.

Coal secs?

Analyses No.

Examined by

Ref.

Coal bed name: Local **SHIPPING MINE**

Survey No.

County **Vermillion**

Index No. **1809**

K.—ACTIVE SHIPPING OR LOCAL COAL MINE.

*Supr mine.*