



I.N. Biggs - Tallula

1/2 mi N. of depot

Tipple - 20' wood. old
 Engines - Gasoline - Horsepower about
 Drum Vertical 4'
 Shaft 2 comp. 9x6. Cage wood
 Can. little over 1000 lbs.
 Ventilation: Fan in air comp beside other shaft
 Expulsion
 Drainage. Take out 2 bbl every day

ming methods. - most workings N+E - Clad
 top to S - and so they quit it.

12 cts bu -
 prob 573' K.E. 1099

alt. 590 - to floor - 132.

Air shaft - 104 to top of coal
 Surf. 5' lower at air shaft

C main shaft at 49' + big coal at 204

Dip strong to E - 15-16 ft fall in 300 ft

Copied from notes by E.W. Shaw
 U.S. GS Notebook 1616

Co. No. 10

G.H.C. 7/29

Location checked in field
 7-23-59 K.E. 1099
 R.L. Berger

T. 17N., 7W., Sec. 6
 in village of Tallula
 Tallula Quad.

Menard

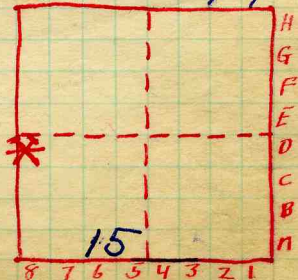

MNC index 6387



Inaccurate - not in files

Yellow clay	10 ±	
Blue very mud with rocks - boulders	25	35
Sand	14	49
Red hard pan. with white pebbles / chalk	12	51
Yellow to red - Soapstone	4 - wood here	55
Slate	17	72
Coal - clay 4'	2' 4"	93' 4" 89' 4"
Rock	1' 4"	94' 8"
Soft rock	8	102' 8"
Rock med. hard	1' 8"	104' 4"
Soft rock	6	104' 10"
Rock	2' 6"	107' 4"
Soft stuff	2'	104
Small rock	6	109' 6"
Soft clay	4	103
Rock	8	121
Soapstone	20 - 25'	146
Coal rock		146 10
Slate	2' 10"	148
Coal		

56' between two coal

(Shaw states 132' to bottom of coal - Not by log)

at Biggs shaft near Tallula

Shaft Biggs - file plant at Tallula

Hard pan -	32	-32
Soapstone	33	65
Chalk rock	25	90
Soft stuff	10"	90 10
Hard rock	1	91 10
Soapstone	6	97 10
Chalk rock of fr.	5	102 10
Bl sand rock	6	108 10
Soft soapstone	10	118
Blue sandstone	5	123

part of E W Shaw
USGS 1616
B1 6/11/10 29

Shaw gives depth 144'

Memorandum 15